

VALVES

MANUAL & AUTOMATIC

VALVES
ARE MECHANICAL
DEVICES THAT
CONTROL THE **FLOW**
AND **PRESSURE** WITHIN
A SYSTEM
OR PROCESS.

PVC - U TRUE UNION BALL VALVE

General:

Material	PVC-U
Seal Material	EPDM-FKM
Ball Seating Joint	PTFE
Dimensions	DN15 - DN100 1/2" - 4" 16A - 100



VALVE SPECIFICATION

- Material: PVC-U.
- Size: DN 15-100 1/2"-4" 16A-100.
- Standard: ASTM - DIN - JIS.
- Connection: Socket - Threaded.
- Colour Handle: Red.
- Body: Dark gray.
- Double Oring seals on stem for added protection full bore sizes.

PRODUCT FEATURES

- Flow is controlled through a hollow ball located in the centre of body.
- Excellent for use in clean fluid service applications with very little to no suspended solids applications.
- The material is nano-modified to improve the pressure resistance and impact resistance thickened valve body for high compression resistance.
- Each Valve 100% Pressure Tested.
- Machined and Polished Ball ensure minimum torque and bubble tight sealing.
- True Union design for easier installation and repairs.
- Built in spanner wrench on the handle for valve disassembly and assembly.

TRUE UNION BALL VALVE PVC - U

COMPONENTS Exploded View

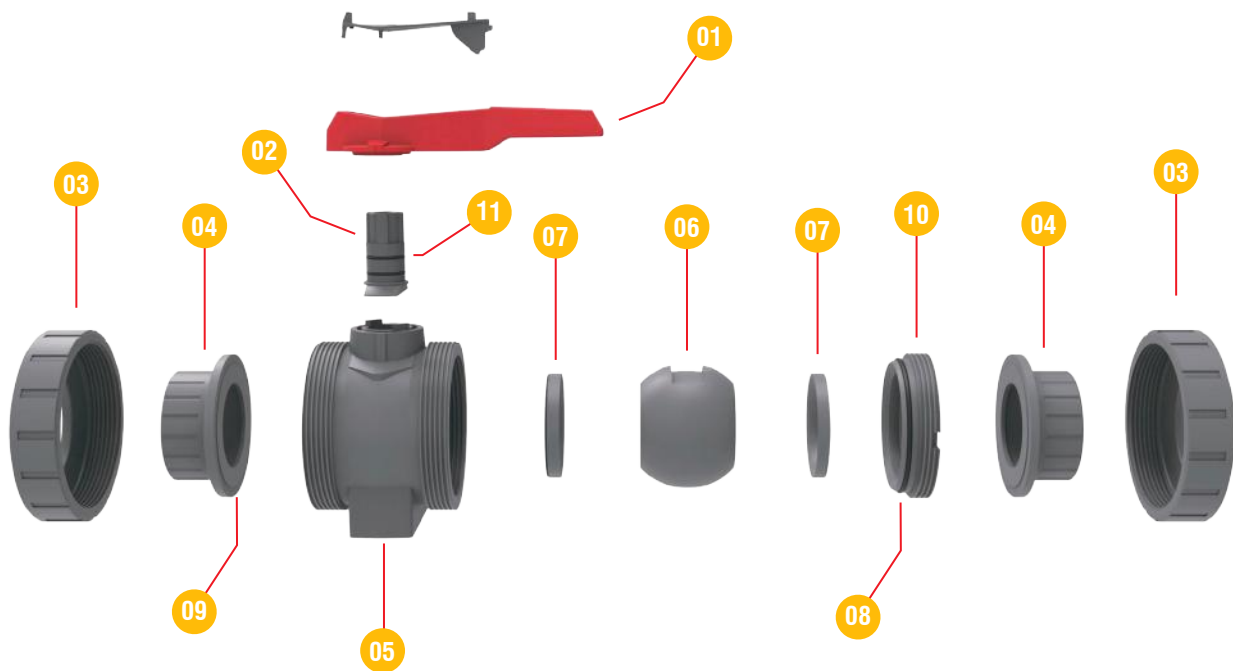

No.	Name	Quantity	Material
01	Lever	1	PVC-U
02	Shaft	1	PVC-U
03	Nut	2	PVC-U
04	Socket	2	PVC-U
05	Body	1	PVC-U
06	Ball	1	PVC-U
07	Ball Seat	2	PTFE
08	O-Ring	2	EPDM/FPM
09	O-Ring	2	EPDM/FPM
10	Seal Carrier	1	PVC-U
11	O-Ring	1	EPDM/FPM

TRUE UNION BALL VALVE PVC - U

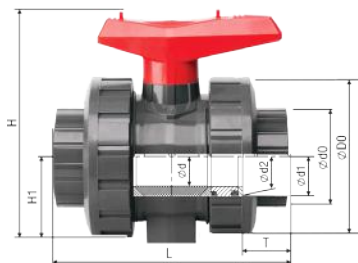

CONNECTION TYPES ASTM SOLVENT SOCKET SERIES

PART#	Size	DIMENSIONS (mm)								
	d	DN	PN	DO	dO	d1	d2	H1	H	L
0507BVK1E10050	1/2"	15	16	52	27	22	21	26	83	108
0507BVK1E10075	3/4"	20	16	59	33	27	27	31	93	123
0507BVK1E10100	1"	25	16	70	41	34	33	39	109	136
0507BVK1E10125	1-1/4"	32	16	85	50	42	42	44	132	159
0507BVK1E10150	1-1/2"	40	16	99	60	49	48	52	143	167
0507BVK1E10200	2"	50	16	122	76	61	60	71	176	183
0507BVK1E10250	2-1/2"	65	16	159	90	73	73	83	232	236
0507BVK1E10300	3"	80	16	192	105	89	89	99	261	249
0507BVK1E10400	4"	100	16	224	128	115	114	115	292	289



CONNECTION TYPES METRIC SOLVENT SOCKET SERIES

PART#	Size	DIMENSIONS (mm)								
	d	DN	PN	DO	dO	d1	d2	H1	H	L
0509BVK1E10050	20	15	16	52	27	20	20	26	83	96
0509BVK1E10075	25	20	16	59	33	25	25	31	93	109
0509BVK1E10100	32	25	16	70	41	32	32	39	109	123
0509BVK1E10125	40	32	16	85	50	40	40	44	132	147
0509BVK1E10150	50	40	16	99	60	50	50	52	143	159
0509BVK1E10200	63	50	16	122	79	63	63	71.30	176	183
0509BVK1E10250	75	65	16	159	90	75	75	83	232	234
0509BVK1E10300	90	80	16	192	105	91	90	99	261	255
0509BVK1E10400	110	100	16	224	128	111	110	115	292	297



MANUAL & AUTOMATIC
VALVES