

VALVES

MANUAL & AUTOMATIC

VALVES
ARE MECHANICAL
DEVICES THAT
CONTROL THE **FLOW**
AND **PRESSURE** WITHIN
A SYSTEM
OR PROCESS.

PVC - U

FLANGED TRUE UNION BALL VALVE

General:

Material	PVC-U
Seal Material	EPDM-FKM
Ball Seating Joint	PTFE
Dimensions	DN15 - DN100 1/2" - 4" 16A - 100



VALVE SPECIFICATION

- Material : PVC-U.
- Size : DN 15 - 100.
- Standard : Flange ANSI 150#
- Connection : Flanged.
- Colour Handle : Red.
- Body : Dark gray.

PRODUCT FEATURES

- Flow is controlled through a hollow ball located in the centre of body.
- Excellent for use in clean fluid service applications with very little to no suspended solids applications.
- The material is nano-modified to Improve the pressure resistance and Impact resistance. thickened valve body for high compression resistance.
- Each valve 100% pressure tested.
- Machined and Polished Ball ensure minimum torque and bubble tight sealing.
- True Union design for easier installation and repairs.
- Built in spanner wrench on the handle for valve disassembly and assembly.

FLANGED TRUE UNION BALL VALVE PVC - U

COMPONENTS Exploded View

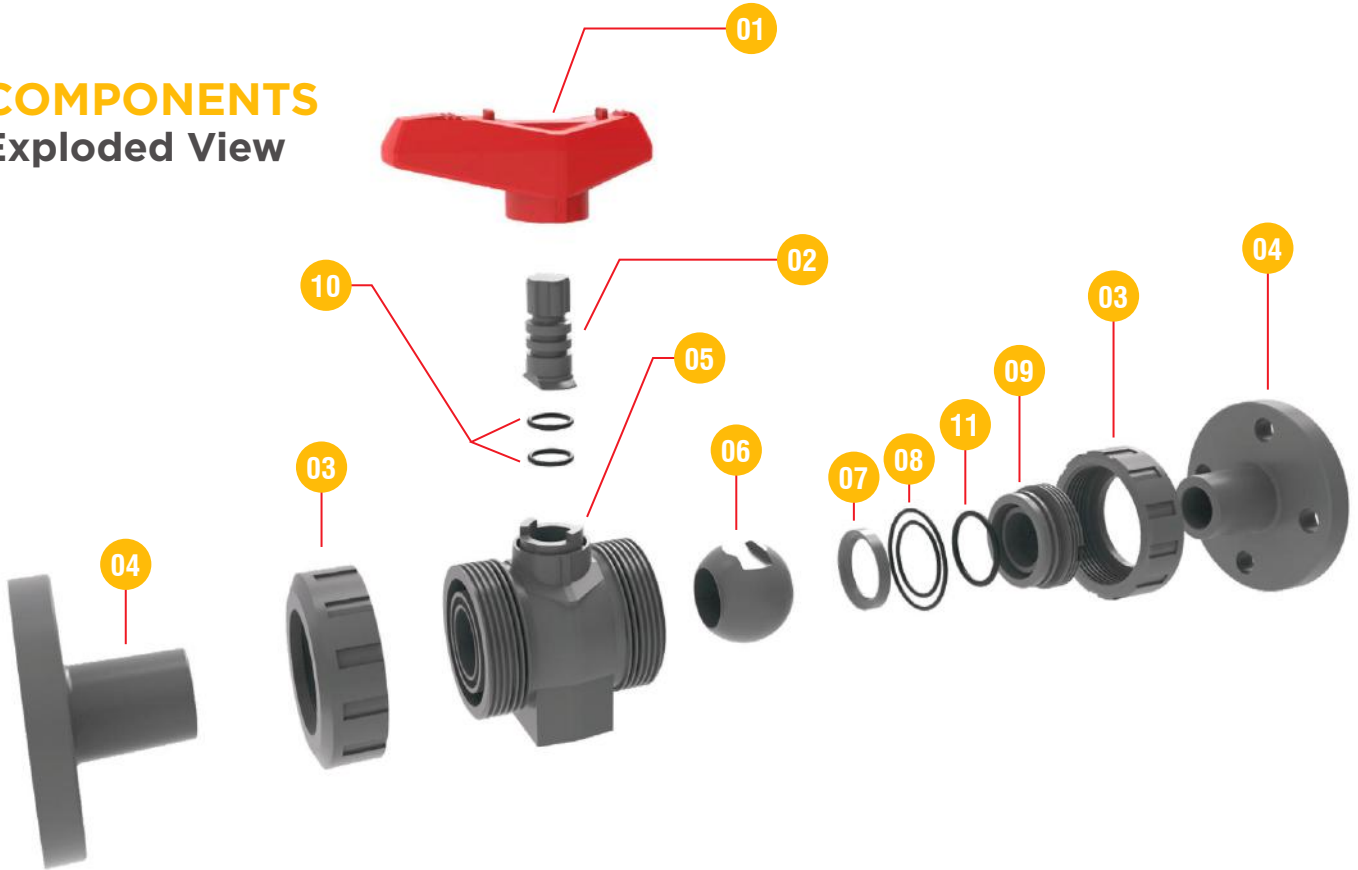

No.	Name	Quantity	Material
01	Lever	1	PVC-U
02	Shaft	1	PVC-U
03	Nut	2	PVC-U
04	Flange	2	PVC-U
05	Body	1	PVC-U
06	Ball	1	PVC-U
07	Ball Seat	2	PTFE
08	O-ring	2	EPDM/FPM
09	Seal Carrier	1	PVC-U
10	O-Ring	2	EPDM/FPM
11	O-Ring	1	EPDM/FPM

FLANGED TRUE UNION BALL VALVE PVC - U

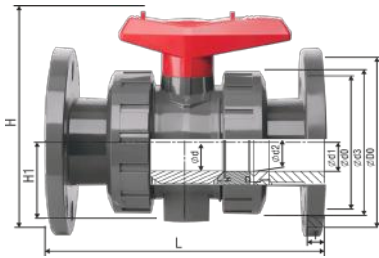

CONNECTION TYPES ANSI B-16.5 FLANGED SERIES

PART#	Size	DIMENSIONS (mm)								
	d	DN	PN	dO	d1	d3	H1	H	T	L
0507BVK1E50050	1/2"	15	16	65	20	52	26	104	13	143
0507BVK1E50075	3/4"	20	16	75	25	59	31	115	14.00	172
0507BVK1E50100	1"	25	16	85	32	70	39	128	15	187
0507BVK1E50125	1-1/4"	32	16	100	40	85	44	158	15	190
0507BVK1E50150	1-1/2"	40	16	110	50	99	52	166	17	212
0507BVK1E50200	2"	50	16	125	63	122	71	198	17	234
0507BVK1E50250	2-1/2"	65	16	145	75	159	83	241	18	290
0507BVK1E50300	3"	80	16	160	91	192	99	261	18	310
0507BVK1E50400	4"	100	16	180	111	224	115	287	18	372

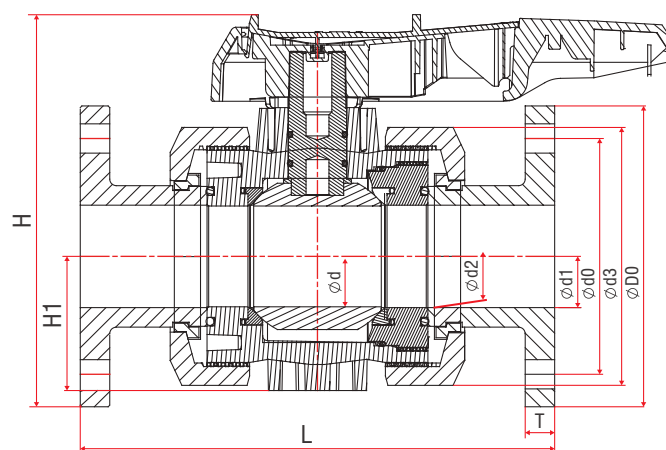



MANUAL & AUTOMATIC
VALVES