

# VALVES

MANUAL & AUTOMATIC

**VALVES**  
ARE MECHANICAL  
DEVICES THAT  
CONTROL THE **FLOW**  
AND **PRESSURE** WITHIN  
**A SYSTEM**  
OR PROCESS.

**PVC - U**  
**TRUE UNION**  
**BALL VALVE**  
**VKD**

**General:**

Material	PVC-U
Seal Material	EPDM-FPM
Ball Seating Joint	PTFE
Dimensions	DN10 - DN50



**VALVE**  
**SPECIFICATION**

- Material : PVC-U.
- Size : DN 10 - 50.
- Standard - Construction Criteria:  
 EN ISO 16135, EN ISO 1452, EN ISO 15493  
 Test Methods and Requirements :  
 ISO 9393.
- Installation Criteria :  
 DVS 2204, DVS 2221, UNI 11242  
 Actuator Couplings : ISO 5211.
- Connection : Socket, Threaded and  
 Flanging System.
- Colour : Dark gray.

**PRODUCT**  
**FEATURES**

- Designed for industrial application resulting in  
 higher number of leak free operation cycles.
- Handle made from HIPVC can also be used as tool  
 to adjust ball seat carrier.
- Built-in lockout system to prevent undesirable  
 operation dual shaft seal eliminates leakage.
- Floating full bore ball with high surface finish.
- Can be mounted with electric or pneumatic act  
 uator or using PQ adaptor.

## TRUE UNION BALL VALVE - VKD PVC - U

### COMPONENTS Exploded View

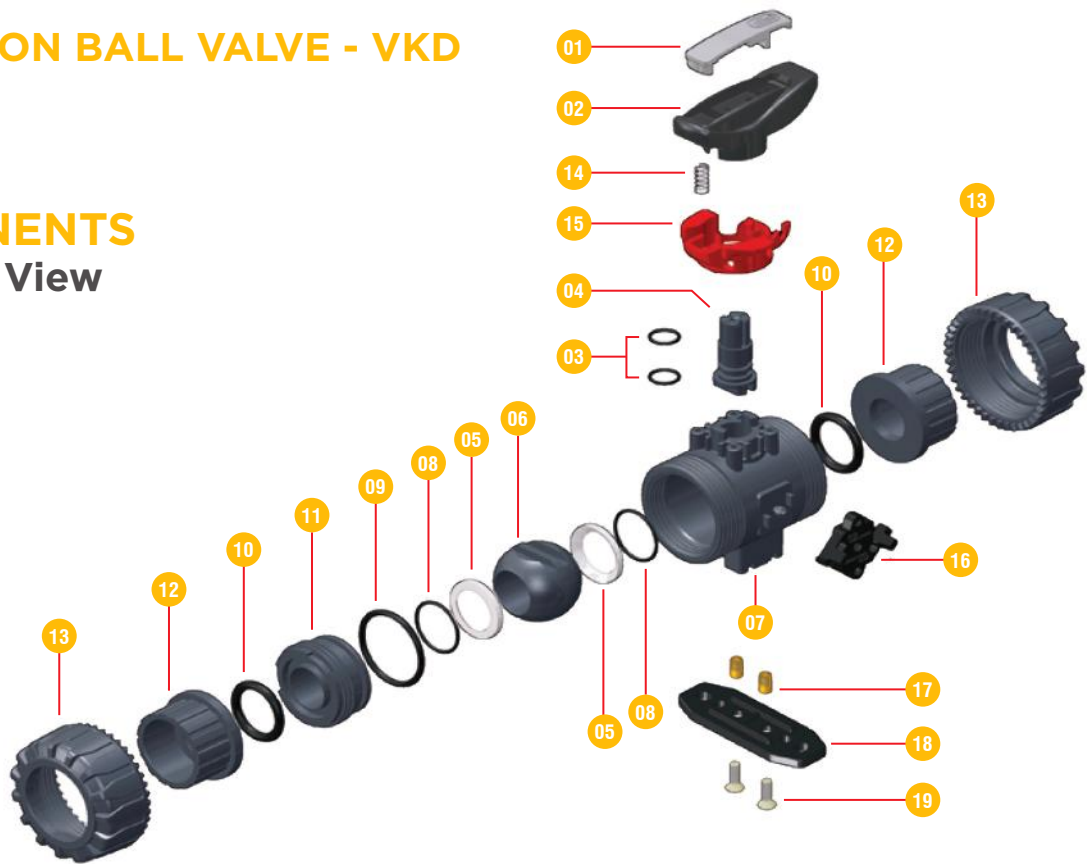

No.	Name	Quantity	Material
01	Handle Insert	1	PVC-U
02	Handle	1	HIPVC
03	Stem O-rings	2	EPDM-FPM
04	Stem	1	PVC-U
05	Ball Seat	2	PTFE
06	Ball	1	PVC-U
07	Body	1	PVC-U
08	Ball Seat O-rings	2	EPDM-FPM
09	Radial Seal O-ring	1	EPDM/FPM
10	Socket Seal O-ring	2	EPDM/FPM
11	Ball Seat Carrier	1	PVC-U
12	End Connector	2	PVC-U
13	Union Nut	2	PVC-U
14	Spring	1	Stainless steel
15	Handle Safety Block	1	PP-GR
16	DUAL BLOCK	1	POM
17	Threaded inserts	2	Stainless steel
18	Distance plate	1	PP - GR
19	Screw	2	Stainless steel

## TRUE UNION BALL VALVE - VKD PVC - U

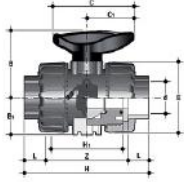

### CONNECTION TYPES METRIC SOLVENT SOCKET SERIES

PART#	Size	DIMENSIONS (mm)										
	d	DN	PN	B	B1	C	C1	E	H	H1	L	g
0509VKD1E10035	16	10	16	54	29	67	40	54	149	65	14	2154
0509VKD1E10050	20	15	16	54	29	67	40	54	124	65	16	220
0509VKD1E10075	25	20	16	65	34.5	85	49	65	144	70	19	340
0509VKD1E10100	32	25	16	69.5	39	85	49	73	154	78	22	443
0509VKD1E10125	40	32	16	82.5	46	108	64	86	174	88	26	693
0509VKD1E10150	50	40	16	89	52	108	64	98	194	93	31	945
0509VKD1E10200	63	50	16	108	62	134	76	122	224	111	38	1607

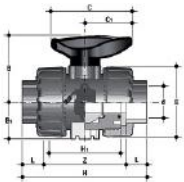

### CONNECTION TYPES ASTM SOLVENT SOCKET SERIES

PART#	Size	DIMENSIONS (mm)										
	d	DN	PN	B	B1	C	C1	E	H	H1	L	g
0507VKD1E10035	3/8"	10	16	54	29	67	40	54	103	65	14.5	2154
0507VKD1E10050	1/2"	15	16	54	29	67	40	54	103	65	16.5	220
0507VKD1E10075	3/4"	20	16	65	34.5	85	49	65	115	70	19	340
0507VKD1E10100	1"	25	16	69.5	39	85	49	73	128	78	22.5	443
0507VKD1E10125	1 1/4"	32	16	82.5	46	108	64	86	146	88	26	693
0507VKD1E10150	1 1/2"	40	16	89	52	108	64	98	164	93	30	945
0507VKD1E10200	2"	50	16	108	62	134	76	122	199	111	36	1607



### CONNECTION TYPES BSP FEMALE THREADED SERIES

PART#	Size	DIMENSIONS (mm)										
	d	DN	PN	B	B1	C	C1	E	H	H1	L	g
0507VKD1E30035	3/8"	10	16	54	29	67	40	54	103	65	12	215
0507VKD1E30050	1/2"	15	16	54	29	67	40	54	110	65	15	210
0507VKD1E30075	3/4"	20	16	65	34.5	85	49	65	116	70	16	335
0507VKD1E30100	1"	25	16	69.5	39	85	49	73	134	78	19	448
0507VKD1E30125	1 1/4"	32	16	82.5	46	108	64	86	153	88	21	578
0507VKD1E30150	1 1/2"	40	16	89	52	108	64	98	156	93	21	955
0507VKD1E30200	2"	50	16	108	62	134	76	122	186	111	26	1667



MANUAL & AUTOMATIC  
VALVES