

VALVES

MANUAL & AUTOMATIC

VALVES
ARE MECHANICAL
DEVICES THAT
CONTROL THE **FLOW**
AND **PRESSURE** WITHIN
A SYSTEM
OR PROCESS.

PVC - U
WAFER
CHECK VALVE
K4

General:

Seal materials	EPDM, FPM
Dimensions	DN65/d75/2 1/2" DN250/d250,D280/10"
Pressure Rates	PN10, PN16, PN6
Connections	WAFER / FLANGED



VALVE
SPECIFICATION

- Check valve allows passage of fluid In a single direction.
- Valve Is designed to be fixed directly between stubs and flanges.
- Flap stopper and body stiffening ribs for increased strength.
- Mounitng between DIN -ANSI - JIS.

PRODUCT
FEATURES

- Excellent flow rates.
- Disc opening upto 85 degrees.
- Non-wetted SS springs.
- Horizontal and vertical installation.
- Tight as of max 0.3 bar counter pressure.

WAFER CHECK VALVE K4 PVC-U

COMPONENTS Exploded View

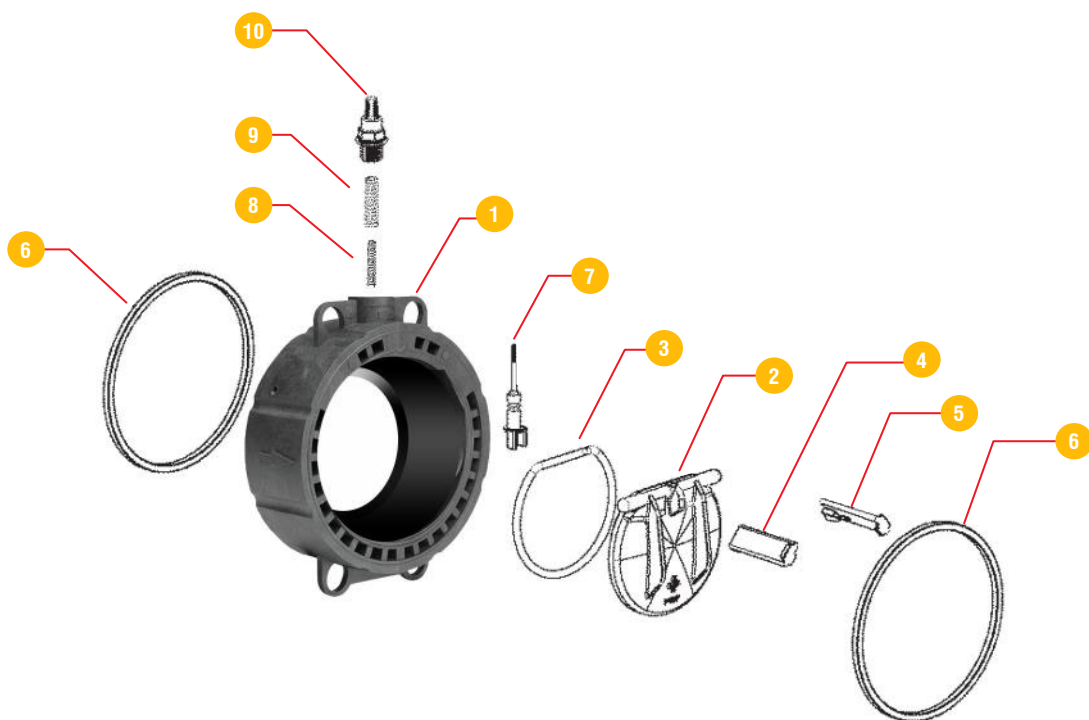

No.	Name	Quantity	Material
1	Body	1	PVC-U
2	Disc	1	PVC-U
3	O-Ring Disc	1	EPDM
4	X-Ring Disc	1	EPDM
5	Fixing Bolt Left	2	SS
6	Fixing Bolt Right	1	SS
7	Indicator Pin with O-Ring	1	PP
8	Spring PN3	2	SS
9	Spring PN7 / PN6 fur PP	1	SS
10	Cap Transparent	2	PP

WAFER CHECK VALVE K4 PVC-U

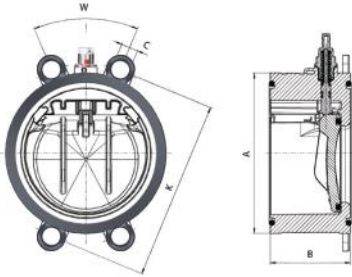

CONNECTION TYPES DIN / ASTM WAFLER FLANGED SERIES

PART #	Size	DIMENSIONS (mm)					
	d	DN	PN	A	B	C	K
0510CU40200	63	50	16	136	187	54	125-145
0510CU40250	75	65	16	136	187	54	125-145
0510CU40300	90	80	16	130	221	58	148-160
0510CU40400	110	100	16	151	242	59	178-190
0510CU40450	125	110	16	170	260	67	190
0510CU40500	140	125	16	190	277	73	210-216
0510CU40600	160	150	10	217	297	80	235-241
0510CU40800	200	175	10	250	329	95	292-298
0510CU41000	250	225	10	322	370	128	350-352
0510CU41200	315	250	10	370	480	131	400-432



MANUAL & AUTOMATIC
VALVES