

# HDPE 100

## PE FITTINGS

**POLYETHYLENE**  
GOOD  
**CHEMICAL**  
RESISTANCE MATERIAL  
**STRENGTH AND RIGIDITY**  
WITHIN A TEMPERATURE  
RANGE OF.  
**40° C and + 80° C.**



**PE 100**

# EQUAL TEE

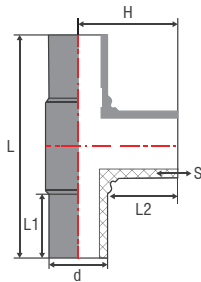
**SDR 9 - PN 20**

PART #	DIAMETER Ød	L	L1	L2	H	S
0329LE900200HP	63	182	58	56	90	<b>7.00</b>
0329LE900250HP	75	232	70	70	117	<b>8.33</b>
0329LE900300HP	90	240	70	70	120	<b>10.00</b>
0329LE900400HP	110	265	70	70	133	<b>11.11</b>
0329LE900450HP	125	305	80	80	150	<b>13.8</b>
0329LE900500HP	140	320	80	80	160	<b>15.55</b>
0329LE900600HP	160	348	85	85	176	<b>17.77</b>
0329LE900700HP	180	400	90	90	197	<b>20.00</b>
0329LE900800HP	200	420	95	95	205	<b>22.22</b>
0329LE900900HP	225	485	90	110	242	<b>25.00</b>
0329LE901000HP	250	430	110	95	230	<b>27.77</b>
0329LE901100HP	280	535	90	95	275	<b>31.11</b>
0329LE901200HP	315	500	90	95	302	<b>35.00</b>
0329LE901300HP	355	565	100	100	302	<b>38.88</b>
0329LE901400HP	400	655	112	112	330	<b>44.44</b>



[WWW.HYDROPLAST.PK](http://WWW.HYDROPLAST.PK)

**HDPE 100**  
**PE FITTINGS**